

■ **OVERALL SITE PLAN**  
SCALE 1:1000

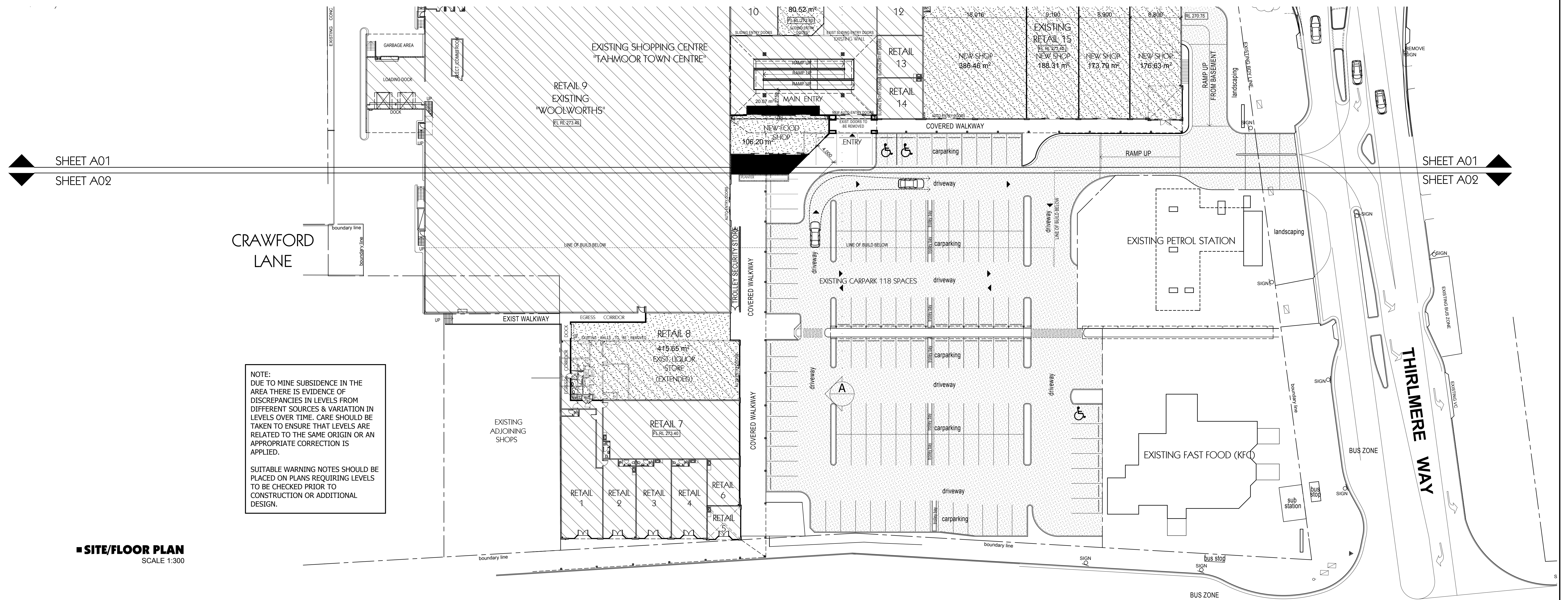

■ **SITE/FLOOR PLAN**  
SCALE 1:300

NOTE:  
DUE TO MINE SUBSIDENCE IN THE AREA THERE IS EVIDENCE OF DISCREPANCIES IN LEVELS FROM DIFFERENT SOURCES & VARIATION IN LEVELS OVER TIME. CARE SHOULD BE TAKEN TO ENSURE THAT LEVELS ARE RELATED TO THE SAME ORIGIN OR AN APPROPRIATE CORRECTION IS APPLIED.

SUITABLE WARNING NOTES SHOULD BE PLACED ON PLANS REQUIRING LEVELS TO BE CHECKED PRIOR TO CONSTRUCTION OR ADDITIONAL DESIGN.

Issue	By	Description	Date	General Notes:	Project	Client	Title	Activity Type	Job No.	Sheet No.	Issue
A	CZ	FOR DEVELOPMENT APPLICATION	16.12.09	1) All dimensions and floor areas are to be verified by the Builder prior to the commencement of any building work. Any discrepancies are to be brought to the attention of the designer.	PROPOSED EXPANSION TO TAHMOOR TOWN CENTRE AT REMEMBRANCE DRIVE TAHMOOR	BALDEK PTY LTD	O/A SITE PLAN - SITE/ GROUND FLOOR PLAN PART B	DA	1183-09	A03	D
B	CZ	FOR DEVELOPMENT APPLICATION	27.01.10	2) Levels shown are approximate unless accompanied by reduced levels.							
C	CZ	FOR DEVELOPMENT APPLICATION	31.05.10	3) Figured dimensions must be taken in preference to scaling.							
D	CZ	FOR DEVELOPMENT APPLICATION	24.08.10	4) All boundary clearances must be verified by the surveyor prior to the commencement of 5) Where engineering drawings are required such must take preference to this drawing 6) Stormwater to be discharged to Council's requirements and AS 3500.3-1990. 7) All services to be located and verified by the Builder with relevant authorities before							
				COPYRIGHT: This design and the associated documents is subject to copyright laws and may not be reproduced in any form without written consent from Algorry Zappia & Associates Pty Ltd.							

ALGORY ZAPPIA & ASSOCIATES PTY. LTD  
Consulting Civil & Structural Engineers & Building Designers  
Suite 4, Level 1, 84 Bathurst Street, Liverpool NSW 2170  
P.O. Box 993, Liverpool Business Centre, NSW 2171  
Tel: 9609 3133 / 9602 0303 Fax: 9601 6903  
E-mail: azappia@optusnet.com.au

Project No. P1773  
Job No. 1183-09  
Sheet No. A03  
Issue D